

THERMO CLIP™ SERIES

- FIXED-WIRE OVER-TEMPERATURE INDICATOR CLIPS FOR ELECTRICAL EQUIPMENT

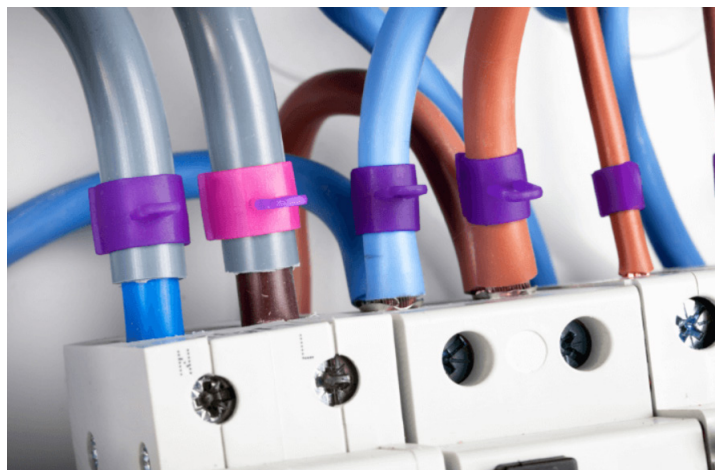

The Thermo Clip™ Series serve as over-temperature indicators for electrical assets.

Using a patented Thermochromic technology, these easily-installed clips provide a colour-changing visual indicator that work as part of the visual component in the inspection process prior to and between infrared and ultrasound inspections.

With a memory-effect feature, these non-conductive clips can also let inspectors see a permanent record of over-temperature excursions in intermittently loaded systems.

The clips turn pink (permanently) when exposed to over-temperature.

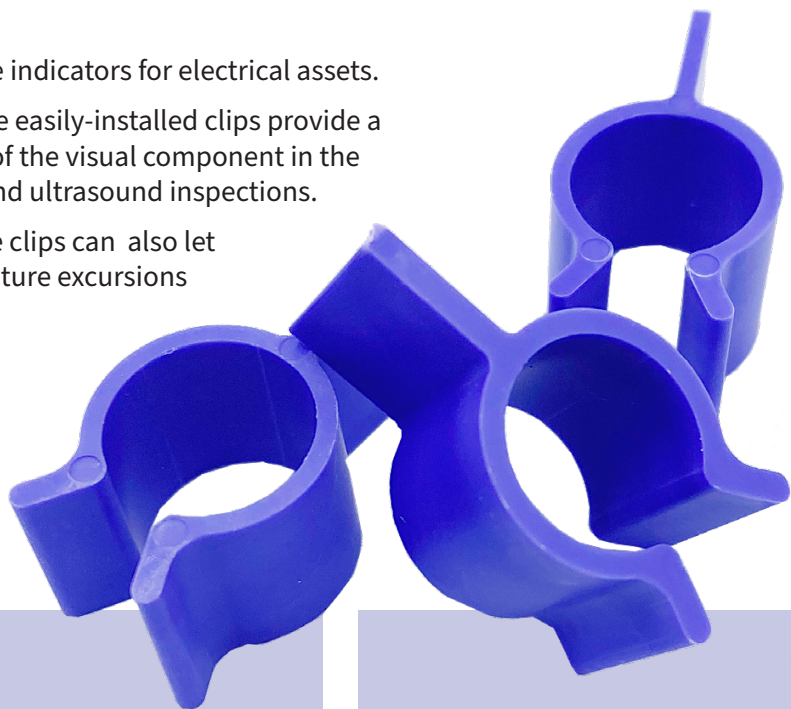

Simple Application

Easy and quick push-on installation means no de-energizing or disconnection is needed

Easy to Read

The thermochromic material provides a highly-visible predictive warning when viewing through inspection windows

Broad Coverage

Multiple models available to provide for varying wire sizes 2.3-31mm diameter. Suitable for circuits rated 3-600 V AC or V DC

H170	H270	H370	H470	H570
17-12 AWG Wire Range	10-6 AWG Wire Range	4-2/0 AWG Wire Range	3/0-350 MCM Wire Range	400-750 MCM Wire Range
2.3-4.2 mm OD	4.8-7.1 mm OD	8-13.6 mm OD	13.8-23 mm OD	23-31 mm OD

HEIGHT = 7mm

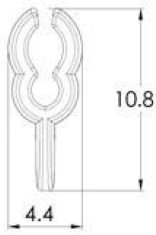

HEIGHT = 7mm



HEIGHT = 10mm

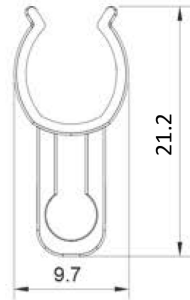

HEIGHT = 14mm

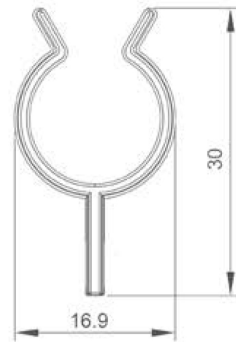

HEIGHT = 14.5mm

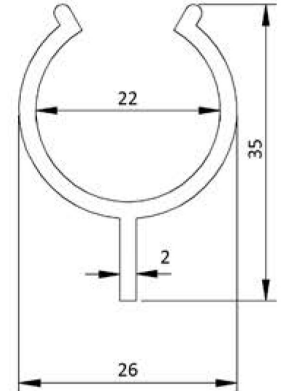

DIMENSIONS IN MILLIMETRES
NOTE: IMAGES ARE NOT TO SCALE

Physical Properties	
Base Materials	5-10% Thermochromic Masterbatch. 90-95% Polypropylene, flame retardant to UL94V0 self extinguishing rating, nonhalogenated.
Initial Color Change Temperature	53°C
Permanent Color Change Temperature	71°C
Tolerance	+/- 1°C
Response Time	5 to 20 Seconds
Storage	Store at room temperature & humidity (i.e. 16°C to 27°C & 40% to 60% RH)
Product Lifespan	Replace overtemperature connection indicators within a maximum lifespan interval of 5 years.

***Installation:** Thermo Clip™ Series Clips are designed to be push fitted only onto the outer insulation of a cable, adjacent (15mm-30mm distance) to its connection terminal. Thermo Clip™ should not be inserted anywhere into the current carrying path of the circuit or directly attached to bare live metal parts of the circuit.

***Caution:** Thermo Clip™ Series are designed for use on electrical cables and as such installation must be assessed by a competent electrician licensed to applicable local requirements prior to their application.

Specifications are subject to change without notice. For the most up-to-date specs, go to www.iriss.com